

REFER DRG. 21122/SD18 FOR CONTINUATION OF DEVELOPMENT

LEGEND	EXISTING	PROPOSED	FUTURE
STORMWATER PIPE			
STORMWATER PIT			
ENDWALL			
VEHICLE CROSSING			
POWERCOR SERVICE PIT			
ELECTRICAL CONDUIT			
UNDERGROUND POWER			
OVERHEAD POWER			
WATER CONDUIT			
WATER MAIN			
FIREPLUG			
TELECOM. PIT			
TELECOM. CABLE			
TELECOM. CONDUIT			
GAS CABLE			
GAS CONDUIT			
PRESSURE SEWER MAIN			
SEWER BOUNDARY KIT			
HOUSE DRAINAGE BLOCK			
PERMANENT SURVEY MARK			
PUBLIC LIGHT AND CONDUIT			
STABILISED SAND BACKFILL			

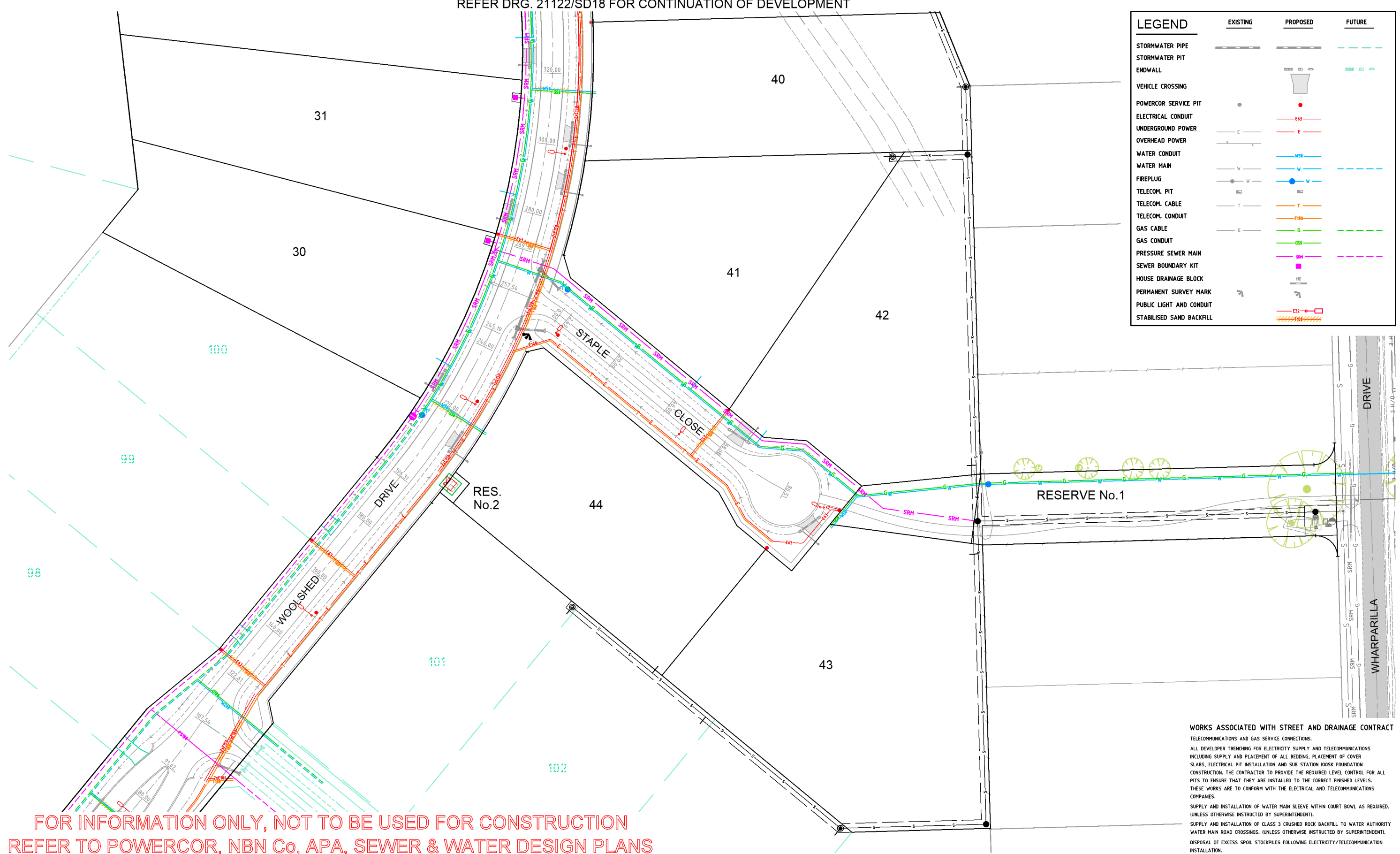

FOR INFORMATION ONLY, NOT TO BE USED FOR CONSTRUCTION
REFER TO POWERCOR, NBN Co, APA, SEWER & WATER DESIGN PLANS

REFER DRG. 21122/SD16 FOR CONTINUATION OF DEVELOPMENT

WORKS ASSOCIATED WITH STREET AND DRAINAGE CONTRACT
TELECOMMUNICATIONS AND GAS SERVICE CONNECTIONS.
ALL DEVELOPER TRENCHING FOR ELECTRICITY SUPPLY AND TELECOMMUNICATIONS INCLUDING SUPPLY AND PLACEMENT OF ALL BEDDING, PLACEMENT OF COVER SLABS, ELECTRICAL PIT INSTALLATION AND SUB STATION KIOSK FOUNDATION CONSTRUCTION. THE CONTRACTOR TO PROVIDE THE REQUIRED LEVEL CONTROL FOR ALL PITS TO ENSURE THAT THEY ARE INSTALLED TO THE CORRECT FINISHED LEVELS. THESE WORKS ARE TO CONFORM WITH THE ELECTRICAL AND TELECOMMUNICATIONS COMPANIES.
SUPPLY AND INSTALLATION OF WATER MAIN SLEEVE WITHIN COURT BOWL AS REQUIRED. UNLESS OTHERWISE INSTRUCTED BY SUPERINTENDENT.
SUPPLY AND INSTALLATION OF CLASS 3 CRUSHED ROCK BACKFILL TO WATER AUTHORITY WATER MAIN ROAD CROSSINGS. UNLESS OTHERWISE INSTRUCTED BY SUPERINTENDENT.
DISPOSAL OF EXCESS SPOIL STOCKPILES FOLLOWING ELECTRICITY/TELECOMMUNICATION INSTALLATION.

WARNING
BEWARE OF UNDERGROUND SERVICES
The locations of underground services are approximate only and their exact position should be proven on site. No guarantee is given that all existing services are shown.

NOTE 1
BEWARE OF EXISTING OVERHEAD POWER CABLES.

SERVICES	OFFSET - TITLE BOUNDARY				
	MURRAY VALLEY HWY	WOOLSHED DRIVE	CARDING COURT	STAPLE CLOSE	JUMBUCK WAY
GAS	4.0m	2.6m	4.1m	2.6m	2.6m
WATER	4.4m	3.0m	4.5m	3.0m	3.0m
TELECOMMUNICATIONS		2.7m or 3.2m	2.1m	2.7m	3.2m
POWERCOR	2.0m	3.1m or 3.6m	2.5m	3.1m	3.6m
PRESSURE SEWER		1.0m	1.0m	1.0m	1.0m

Scale 1: 500 @ A1

Chris Smith & ASSOCIATES PTY LTD

CIVIL ENGINEERS
URBAN & REGIONAL PLANNERS
LEVEL 1 / 135 FRYERS STREET, SHEPPARTON, VIC. 3630
PH: (03) 5820 7700 FAX: (03) 5822 4878 www.csmith.com.au

LAND SURVEYORS
PROJECT MANAGERS

Designed Lisa Stevens June 2022
Drawn Lisa Stevens November 2022
Checked Scott Golightly April 2023
Approved

Wharparilla West P/L
Wharparilla Estate - Stage 8
Murray Valley Highway, Echuca

Street & Drainage Construction Services Layout Plan 2
Drawing No. 21200/SD17
Sheet No. 17 of 33

Rev. -
21200 SD03v0.dwg

© Chris Smith & Associates ABN 14 627 892 064
THIS DOCUMENT IS COPYRIGHT AND MAY ONLY BE USED FOR THE PURPOSE FOR WHICH IT WAS COMMISSIONED. UNAUTHORISED USE IS PROHIBITED. ALL DIMENSIONS AND LEVELS TO BE CHECKED ON THE PROJECT BEFORE COMMENCING ANY WORKS OR SHOP DRAWINGS.
DRAWINGS NOT TO BE SCALED.

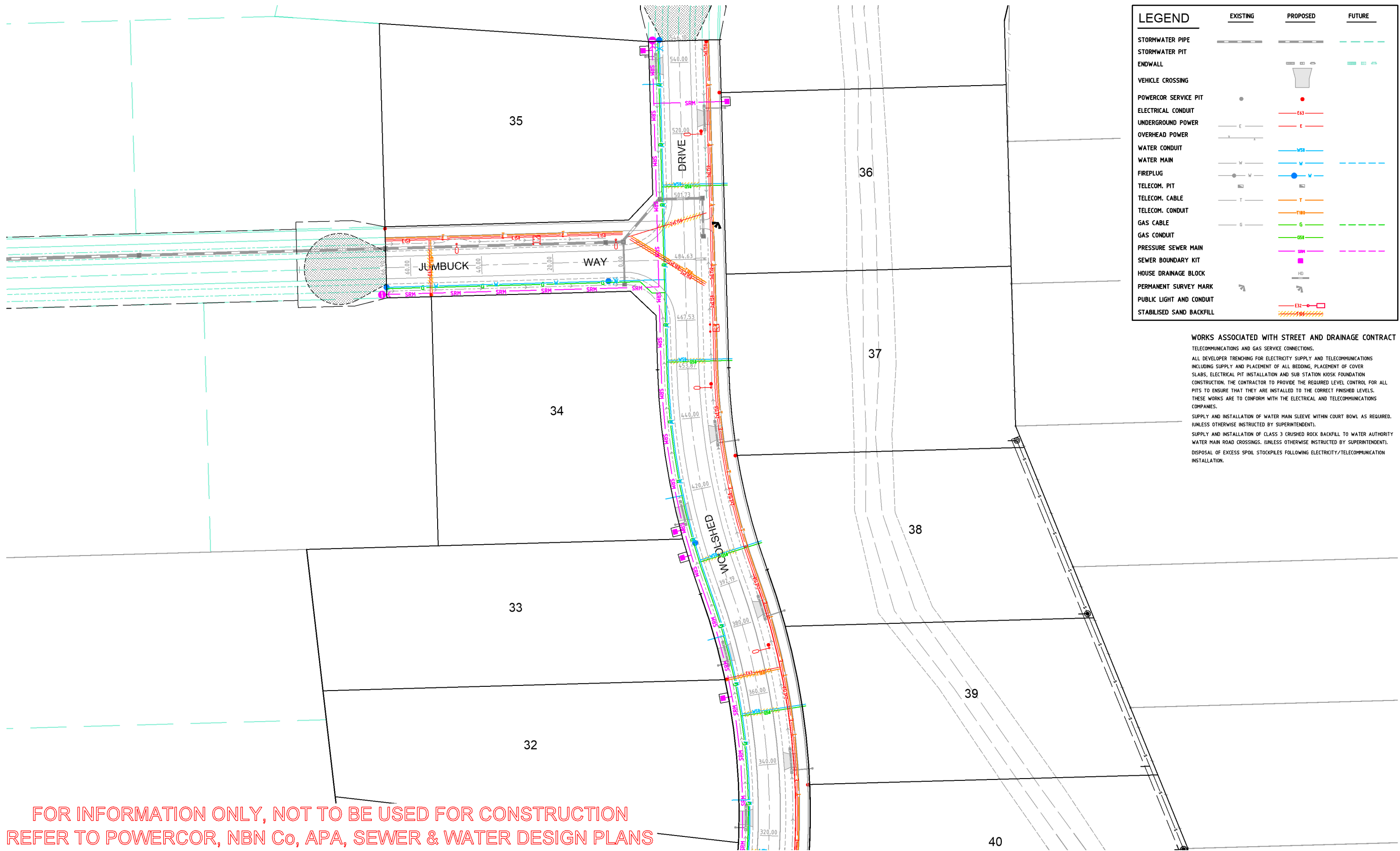

FOR INFORMATION ONLY, NOT TO BE USED FOR CONSTRUCTION
REFER TO POWERCOR, NBN Co, APA, SEWER & WATER DESIGN PLANS

REFER DRG. 21122/SD17 FOR CONTINUATION OF DEVELOPMENT



WARNING
BEWARE OF UNDERGROUND SERVICES
The locations of underground services are approximate only and their exact position should be proven on site. No guarantee is given that all existing services are shown.

NOTE !
BEWARE OF EXISTING OVERHEAD POWER CABLES.

REVISION	DATE	ZONE

SERVICES	OFFSET - TITLE BOUNDARY				
	MURRAY VALLEY HWY	WOOLSHED DRIVE	CARDING COURT	STAPLE CLOSE	JUMBUCK WAY
GAS	4.0m	2.6m	4.1m	2.6m	2.6m
WATER	4.4m	3.0m	4.5m	3.0m	3.0m
TELECOMMUNICATIONS		2.7m or 3.2m	2.1m	2.7m	3.2m
POWERCOR	2.0m	3.1m or 3.6m	2.5m	3.1m	3.6m
PRESSURE SEWER		1.0m	1.0m	1.0m	1.0m

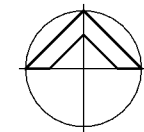

0 5 10 20m
Scale 1 : 500 @ A1

Chris Smith
& ASSOCIATES
PTY LTD

CIVIL ENGINEERS
URBAN & REGIONAL PLANNERS
LEVEL 1 / 135 FRYERS STREET, SHEPPARTON, VIC. 3630
PH: (03) 5820 7700 FAX: (03) 5822 4878
www.csmith.com.au

LAND SURVEYORS
PROJECT MANAGERS
Designed Lisa Stevens June 2022
Drawn Lisa Stevens November 2022
Checked Scott Golightly April 2023
Approved

Wharparilla West P/L
Wharparilla Estate - Stage 8
Murray Valley Highway, Echuca

Street & Drainage Construction
Services Layout Plan 3
Drawing No. 21200/SD18
Sheet No. 18 of 33

Rev. -
21200 SD03v0.dwg
A1

© Chris Smith & Associates ABN 14 627 882 064
THIS DOCUMENT IS COPYRIGHT AND MAY ONLY BE USED FOR THE PURPOSE FOR WHICH IT WAS COMMISSIONED. UNAUTHORISED USE PROHIBITED. ALL DIMENSIONS AND LEVELS TO BE CHECKED ON THE PROJECT BEFORE COMMENCING ANY WORKS OR SHOP DRAWINGS.
DRAWINGS NOT TO BE SCALED.